

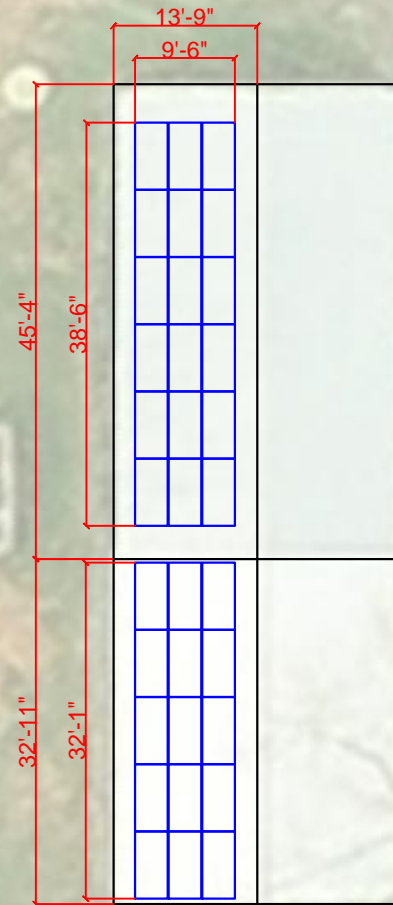

NOTES: 1. EQUIPMENT LOCATION TO BE FIELD VERIFIED
 2. GROUND ACCESS, PATHWAYS, AND VENTILATION PER 2016 NEW YORK STATE UNIFORM CODE











1 SITE PLAN & EQUIPMENT LAYOUT
 Scale: 1/32" = 1'

PV SYSTEM SUMMARY

TOTAL STC DC SYSTEM SIZE	11.055 kW
SOLAR MODULE MODEL	Jinko
SOLAR MODULE STC DC RATING	335 W
SOLAR MODULE INFO	77.0" x 39.1" x 1.57", 58.4 lbs
SOLAR MODULE COUNT	33
STRING SIZE	11M x 3S
RACKING SYSTEM	DYNORAXX PR
PITCH OF ARRAY	3:12
INVERTER MODEL	1 x SE 10000 A-US INV w/ 33 x SE P400 DC OP
ARRAY AZIMUTH	235°
EAVE HEIGHT	11'
INTERCONNECTION VOLTAGE	TBD

LEGEND

-  SOLAR MODULE
-  INV INVERTER
-  EZM EASY TO READ METER
-  SUB SUB PANEL
-  UM UTILITY METER
-  MAIN MAIN BREAKER PANEL
-  GROUND ACCESS AREA
-  VENTING AND PATHWAYS

General Notes

THE INSTALLATION OF PV SYSTEM SHALL BE IN ACCORDANCE WITH THE MOST RECENT NATIONAL ELECTRIC AND BUILDING CODES AND STANDARDS, AS AMENDED BY JURISDICTION

ELECTRICAL STAMP AREA

THIS INFORMATION IS CONFIDENTIAL AND PROPRIETARY TO SOLAR LIBERTY ENERGY SYSTEMS, INC. PLEASE DO NOT SHARE THIS WITH ANYONE UNLESS THERE IS A WRITTEN APPROVAL FROM SOLAR LIBERTY.

No.	Revision/Issue	Date
0	original site plan	08/14/17

SOLARLIBERTY
 THE FUTURE OF ENERGY INDEPENDENCE

6500 Sheridan Drive
 Suite 120
 Buffalo, NY 14221
 866-80-RENEW

**NABCEP
 CERTIFIED**

PV Installation
 Professional

Project Name and Address

Tongore Park Pavilion
 350 Tongore Rd
 Kingston, NY 12401

Drawn By WL	Checked By BWC
Date 08/14/2017	Date 08/14/2017
Scale AS NOTED	Sheet PV-S1

2 PV SYSTEM OVERVIEW
 Scale: N.T.S.



3 AERIAL VIEW
 Scale: N.T.S.



NOTES: 1. EQUIPMENT LOCATION TO BE FIELD VERIFIED
 2. GROUND ACCESS, PATHWAYS, AND VENTILATION PER 2016 NEW YORK STATE UNIFORM CODE

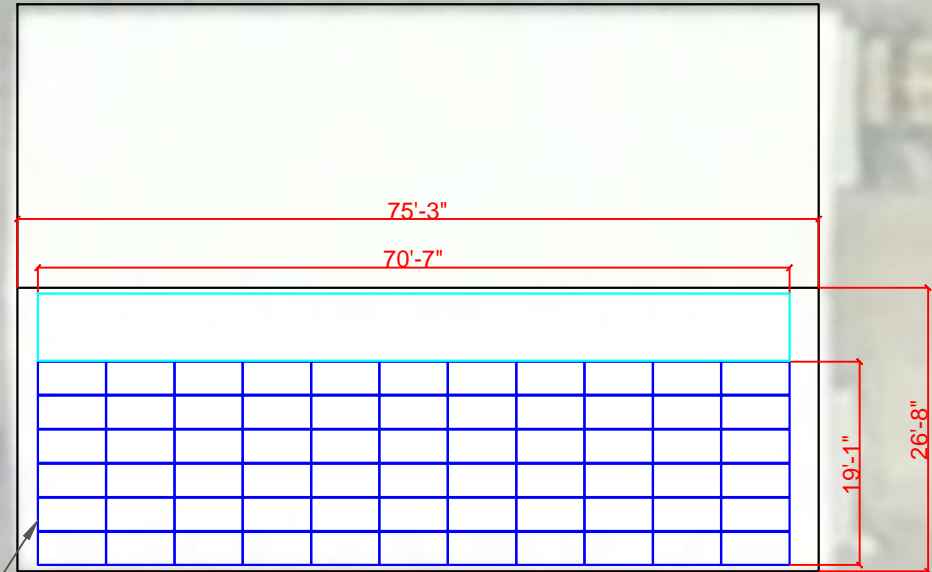

66 Modules
Value Stack

1 SITE PLAN & EQUIPMENT LAYOUT
 Scale: 1/32" = 1'

PV SYSTEM SUMMARY

TOTAL STC DC SYSTEM SIZE	22.11 kW
SOLAR MODULE MODEL	Jinko
SOLAR MODULE STC DC RATING	335 W
SOLAR MODULE INFO	77.0" x 39.1" x 1.57", 58.4 lbs
SOLAR MODULE COUNT	66
STRING SIZE	11M x 6S
RACKING SYSTEM	DYNORAXX PR
PITCH OF ARRAY	4:12
INVERTER MODEL	2 x SE 10000 A-US INV w/ 66 x SE P400 DC OP
ARRAY AZIMUTH	225°
EAVE HEIGHT	12'
INTERCONNECTION VOLTAGE	TBD

LEGEND

- SOLAR MODULE
- INVERTER
- EASY TO READ METER
- SUB PANEL
- UTILITY METER
- MAIN BREAKER PANEL
- GROUND ACCESS AREA
- VENTING AND PATHWAYS

General Notes

THE INSTALLATION OF PV SYSTEM SHALL BE IN ACCORDANCE WITH THE MOST RECENT NATIONAL ELECTRIC AND BUILDING CODES AND STANDARDS, AS AMENDED BY JURISDICTION

ELECTRICAL STAMP AREA

THIS INFORMATION IS CONFIDENTIAL AND PROPRIETARY TO SOLAR LIBERTY ENERGY SYSTEMS, INC. PLEASE DO NOT SHARE THIS WITH ANYONE UNLESS THERE IS A WRITTEN APPROVAL FROM SOLAR LIBERTY.

No.	Revision/Issue	Date
0	original site plan	08/14/17

SOLARLIBERTY
 THE FUTURE OF ENERGY INDEPENDENCE

6500 Sheridan Drive
 Suite 120
 Buffalo, NY 14221
 866-80-RENEW

**NABCEP
 CERTIFIED**

PV Installation
 Professional

Project Name and Address

Marbletown Hwy Garage
 3775 Main St
 Stone Ridge, NY 12484

Drawn By WL	Checked By BWC
Date 08/14/2017	Date 08/14/2017
Scale AS NOTED	Sheet PV-S1

2 PV SYSTEM OVERVIEW
 Scale: N.T.S.



3 AERIAL VIEW
 Scale: N.T.S.



NOTES: 1. EQUIPMENT LOCATION TO BE FIELD VERIFIED

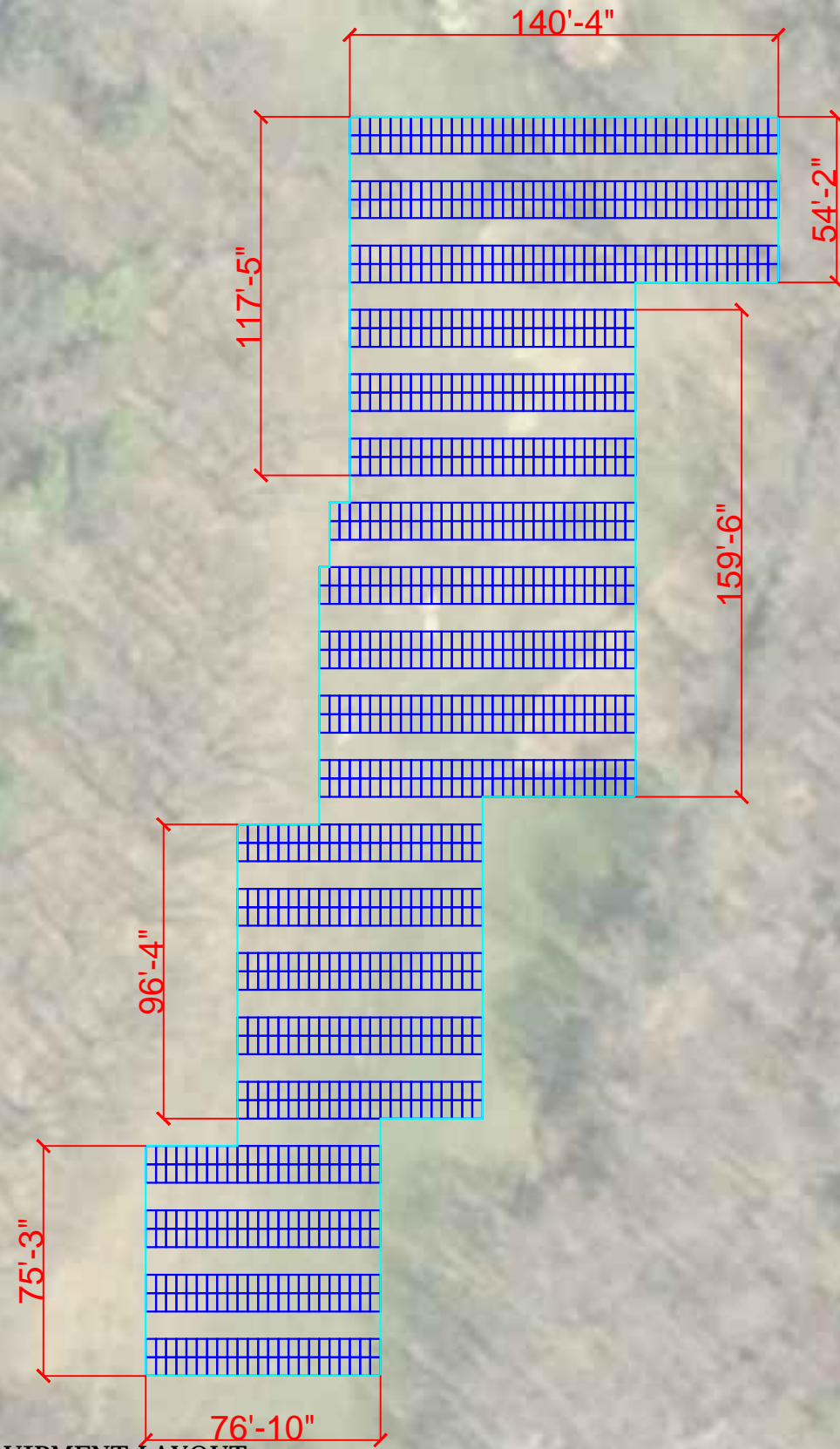









1 SITE PLAN & EQUIPMENT LAYOUT
Scale: 1/128" = 1'

PV SYSTEM SUMMARY

TOTAL STC DC SYSTEM SIZE	385.92 kW
SOLAR MODULE MODEL	Jinko
SOLAR MODULE STC DC RATING	335 W
SOLAR MODULE INFO	77.0" x 39.1" x 1.57", 58.4 lbs
SOLAR MODULE COUNT	1152
STRING SIZE	12 x [16M x 6S]
RACKING SYSTEM	GROUND MOUNT RACKING
PITCH OF ARRAY	20°
INVERTER MODEL	12 x HUAWEI SUN2000-25KTL-US
ARRAY AZIMUTH	180°
RIDGE HEIGHT	3'
INTERCONNECTION VOLTAGE	TBD

LEGEND

-  SOLAR MODULE
-  INVERTER
-  EASY TO READ METER
-  SUB PANEL
-  UTILITY METER
-  MAIN BREAKER PANEL
-  GROUND ACCESS AREA
-  VENTING AND PATHWAYS

General Notes

THE INSTALLATION OF PV SYSTEM SHALL BE IN ACCORDANCE WITH THE MOST RECENT NATIONAL ELECTRIC AND BUILDING CODES AND STANDARDS, AS AMENDED BY JURISDICTION

ELECTRICAL STAMP AREA

THIS INFORMATION IS CONFIDENTIAL AND PROPRIETARY TO SOLAR LIBERTY ENERGY SYSTEMS, INC. PLEASE DO NOT SHARE THIS WITH ANYONE UNLESS THERE IS A WRITTEN APPROVAL FROM SOLAR LIBERTY.

No.	Revision/Issue	Date
0	original site plan	07/31/17

SOLARLIBERTY
THE FUTURE OF ENERGY INDEPENDENCE

6500 Sheridan Drive
Suite 120
Buffalo, NY 14221
866-80-RENEW

NABCEP
CERTIFIED

PV Installation Professional

Project Name and Address

Town of Marbletown
1925 Lucas Turnpike
Cottkill, NY 12419

Drawn By WL	Checked By BWC
Date 07/31/2017	Date 07/31/2017
Scale AS NOTED	Sheet PV-S1

2 PV SYSTEM OVERVIEW
Scale: N.T.S.



3 AERIAL VIEW
Scale: N.T.S.



NOTES: 1. EQUIPMENT LOCATION TO BE FIELD VERIFIED
 2. GROUND ACCESS, PATHWAYS, AND VENTILATION PER 2016 NEW YORK STATE UNIFORM CODE

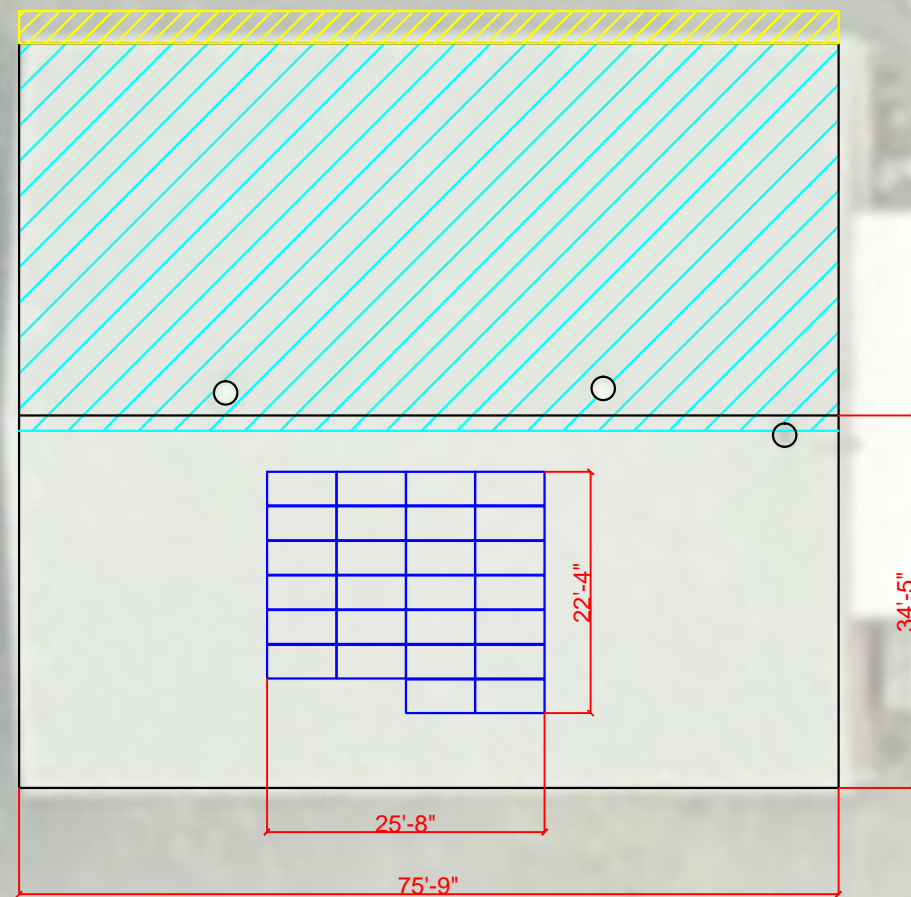

1 SITE PLAN & EQUIPMENT LAYOUT
 Scale: 1/32" = 1'

PV SYSTEM SUMMARY

TOTAL STC DC SYSTEM SIZE	8.71 kW
SOLAR MODULE MODEL	Jinko
SOLAR MODULE STC DC RATING	335 W
SOLAR MODULE INFO	77.0" x 39.1" x 1.57", 58.4 lbs
SOLAR MODULE COUNT	26
STRING SIZE	13M x 2S
RACKING SYSTEM	DYNORAXX PR
PITCH OF ARRAY	4:12
INVERTER MODEL	1 x SE 7600 A-US INV w/ 26 x SE P400 DC OP
ARRAY AZIMUTH	225°
EAVE HEIGHT	11'
INTERCONNECTION VOLTAGE	TBD

LEGEND

- SOLAR MODULE
- INVERTER
- EASY TO READ METER
- SUB PANEL
- UTILITY METER
- MAIN BREAKER PANEL
- GROUND ACCESS AREA
- VENTING AND PATHWAYS

General Notes

THE INSTALLATION OF PV SYSTEM SHALL BE IN ACCORDANCE WITH THE MOST RECENT NATIONAL ELECTRIC AND BUILDING CODES AND STANDARDS, AS AMENDED BY JURISDICTION

ELECTRICAL STAMP AREA

THIS INFORMATION IS CONFIDENTIAL AND PROPRIETARY TO SOLAR LIBERTY ENERGY SYSTEMS, INC. PLEASE DO NOT SHARE THIS WITH ANYONE UNLESS THERE IS A WRITTEN APPROVAL FROM SOLAR LIBERTY.

No.	Revision/Issue	Date
0	original site plan	08/14/17

SOLARLIBERTY
 THE FUTURE OF ENERGY INDEPENDENCE

6500 Sheridan Drive
 Suite 120
 Buffalo, NY 14221
 866-80-RENEW

**NABCEP
 CERTIFIED**

PV Installation Professional

Project Name and Address
 Marletown Old Town Hall
 3775 Main St
 Stone Ridge, NY 12484

Drawn By WL	Checked By BWC
Date 08/14/2017	Date 08/14/2017
Scale AS NOTED	Sheet PV-S1

2 PV SYSTEM OVERVIEW
 Scale: N.T.S.



3 AERIAL VIEW
 Scale: N.T.S.



NOTES: 1. EQUIPMENT LOCATION TO BE FIELD VERIFIED
 2. GROUND ACCESS, PATHWAYS, AND VENTILATION PER 2016 NEW YORK STATE UNIFORM CODE

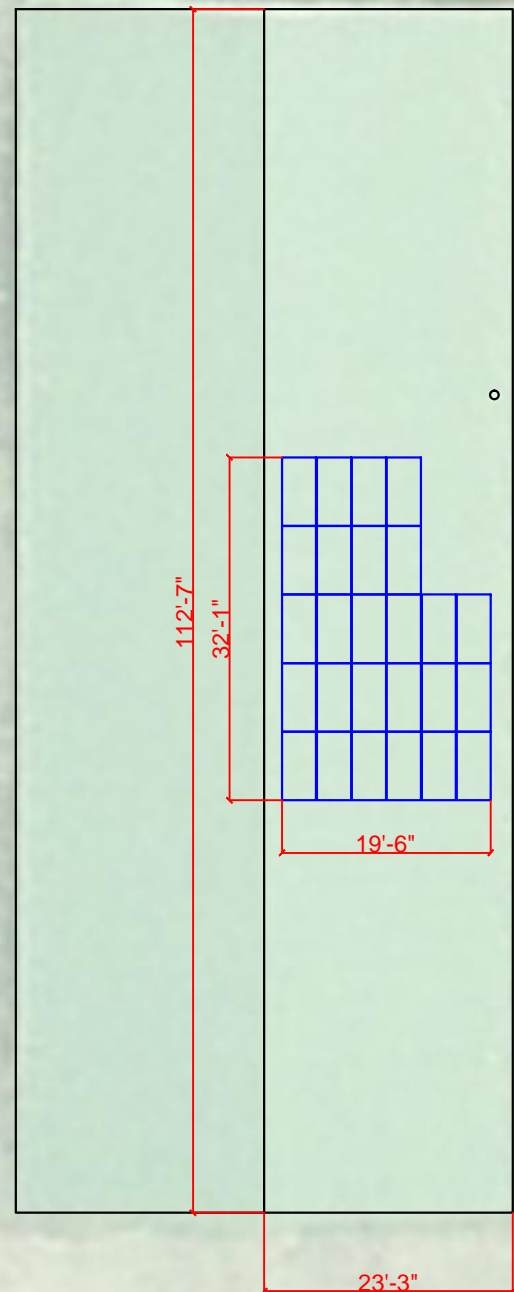









1 SITE PLAN & EQUIPMENT LAYOUT
 Scale: 1/32" = 1'

PV SYSTEM SUMMARY

TOTAL STC DC SYSTEM SIZE	8.71 kW
SOLAR MODULE MODEL	Jinko
SOLAR MODULE STC DC RATING	335 W
SOLAR MODULE INFO	77.0" x 39.1" x 1.57", 58.4 lbs
SOLAR MODULE COUNT	26
STRING SIZE	13M x 2S
RACKING SYSTEM	DYNORAXX PR
PITCH OF ARRAY	3:12
INVERTER MODEL	1 x SE 7600 A-US INV w/ 26 x SE P400 DC OP
ARRAY AZIMUTH	135°
EAVE HEIGHT	18'
INTERCONNECTION VOLTAGE	TBD

LEGEND

-  SOLAR MODULE
-  INVERTER
-  EASY TO READ METER
-  SUB PANEL
-  UTILITY METER
-  MAIN BREAKER PANEL
-  GROUND ACCESS AREA
-  VENTING AND PATHWAYS

General Notes

THE INSTALLATION OF PV SYSTEM SHALL BE IN ACCORDANCE WITH THE MOST RECENT NATIONAL ELECTRIC AND BUILDING CODES AND STANDARDS, AS AMENDED BY JURISDICTION

ELECTRICAL STAMP AREA

THIS INFORMATION IS CONFIDENTIAL AND PROPRIETARY TO SOLAR LIBERTY ENERGY SYSTEMS, INC. PLEASE DO NOT SHARE THIS WITH ANYONE UNLESS THERE IS A WRITTEN APPROVAL FROM SOLAR LIBERTY.

No.	Revision/Issue	Date
0	original site plan	08/14/17

SOLARLIBERTY
 THE FUTURE OF ENERGY INDEPENDENCE
 6500 Sheridan Drive
 Suite 120
 Buffalo, NY 14221
 866-80-RENEW

**NABCEP
 CERTIFIED**
 PV Installation
 Professional

Project Name and Address
 Marbletown Transfer Station
 135 Canal Rd
 High Falls, NY 12440

Drawn By WL	Checked By BWC
Date 08/14/2017	Date 08/14/2017
Scale AS NOTED	Sheet PV-S1

2 PV SYSTEM OVERVIEW
 Scale: N.T.S.



3 AERIAL VIEW
 Scale: N.T.S.



NOTES: 1. EQUIPMENT LOCATION TO BE FIELD VERIFIED
 2. GROUND ACCESS, PATHWAYS, AND VENTILATION PER 2016 NEW YORK STATE UNIFORM CODE

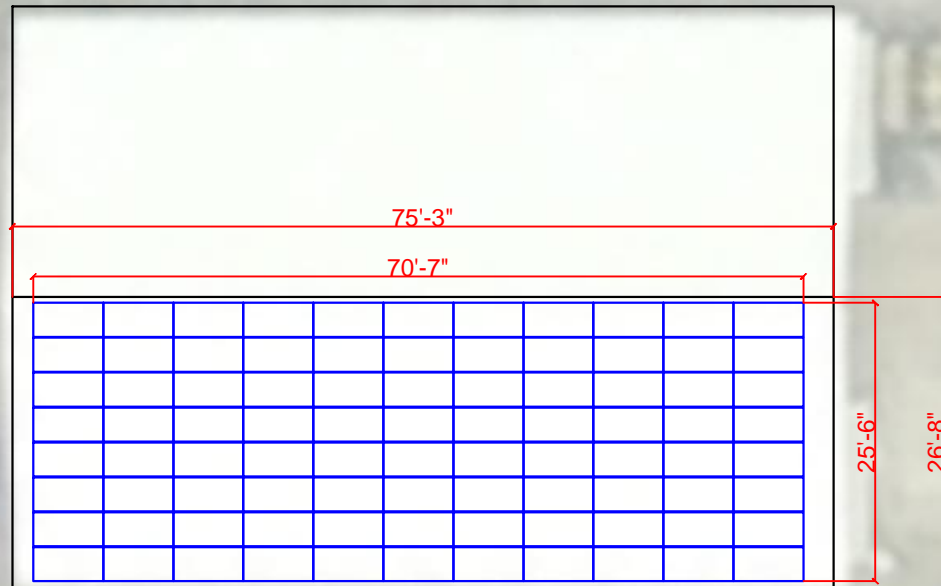









1 SITE PLAN & EQUIPMENT LAYOUT
 Scale: 1/32" = 1'

PV SYSTEM SUMMARY

TOTAL STC DC SYSTEM SIZE	29.48 kW
SOLAR MODULE MODEL	Jinko
SOLAR MODULE STC DC RATING	335 W
SOLAR MODULE INFO	77.0" x 39.1" x 1.57", 58.4 lbs
SOLAR MODULE COUNT	88
STRING SIZE	15M x 4S, 14M x 2S
RACKING SYSTEM	DYNORAXX PR
PITCH OF ARRAY	4:12
INVERTER MODEL	1 x HUAWEI SUN2000-25KTL-US
ARRAY AZIMUTH	225°
EAVE HEIGHT	12'
INTERCONNECTION VOLTAGE	TBD

LEGEND

-  SOLAR MODULE
-  INVERTER
-  EASY TO READ METER
-  SUB PANEL
-  UTILITY METER
-  MAIN BREAKER PANEL
-  GROUND ACCESS AREA
-  VENTING AND PATHWAYS

General Notes

THE INSTALLATION OF PV SYSTEM SHALL BE IN ACCORDANCE WITH THE MOST RECENT NATIONAL ELECTRIC AND BUILDING CODES AND STANDARDS, AS AMENDED BY JURISDICTION

ELECTRICAL STAMP AREA

THIS INFORMATION IS CONFIDENTIAL AND PROPRIETARY TO SOLAR LIBERTY ENERGY SYSTEMS, INC. PLEASE DO NOT SHARE THIS WITH ANYONE UNLESS THERE IS A WRITTEN APPROVAL FROM SOLAR LIBERTY.

No.	Revision/Issue	Date
0	original site plan	08/14/17

SOLARLIBERTY
 THE FUTURE OF ENERGY INDEPENDENCE
 6500 Sheridan Drive
 Suite 120
 Buffalo, NY 14221
 866-80-RENEW

**NABCEP
 CERTIFIED**
 PV Installation
 Professional

Project Name and Address
 Marbletown Hwy Garage
 3775 Main St
 Stone Ridge, NY 12484

Drawn By WL	Checked By BWC
Date 08/14/2017	Date 08/14/2017
Scale AS NOTED	Sheet PV-S1

2 PV SYSTEM OVERVIEW
 Scale: N.T.S.



3 AERIAL VIEW
 Scale: N.T.S.